

BL6-FM7 & BL6-SFM7 7" LED Flush Mount

Catalog #		Prepared by	LiteHarbor
Project		Date	
Notes			



BL6-FM7



BL6-SFM7

ORDER MATRIX | Example: BL6-FM7

A	B	C	D	E	F
A	Series				
BL6-FM7	7" Round LED Flush Mount Ceiling Light				
BL6-SFM7	7" Square LED Flush Mount Ceiling Light				
B	Input Voltage				
	120V				
277	277V				
U	120-277V				
C	Dimmable				
	Non-Dimmable				
DM	Dimmable				
D	LED Available				
Cree	Cree				
Citizen	Citizen				
Epistar	Epistar				
Seoul	Seoul				
Osram	Osram				

Description

An architecturally pleasing, easy to install and low profile slim LED instant mount round and square aperture downlighting.

Slim line, light weight and sleek look, provides more uniform light and an instant on.

It is a low profile downlight intended for ceiling or wall mount applications.

This luminaire offers the appearance of a recessed downlight but is actually surface mounted.

Applications

Slim LED Flush Mount Downlight is characterized by a completely flat lens with a narrow flange, giving it an architecturally pleasing look.

This downlighting solution offers an affordable alternative to Air-Seal IC recessed housings or Fire-Rated boxes, reducing material and installation costs.

Features

LED 7" flush mount

Decorative flush mount LED fixture

LED 13.5W Equal to a traditional 60W lamp

80 CRI, 1050lm

LED CEILING LIGHT



E	Color Temperature
27K	2700K
40K	4000K
50K	5000K
60K	6000K
	Tunable
	(3000K, 4000K, 5000K, choose any 2 of them)

F	Emergency System
	Without Emergency Battery Backup
EM	With Emergency Battery Backup

90 CRI, 850lm

80% energy savings

Damp location listed

Mounts directly to 3" and 4" junction boxes

Easy to install

Finish

Available in White, Brushed Nickel, and Bronze

Application

Residential

Office

Retail

Hospitality

Listing & Warranty

ENERGY STAR

2-Year Limited Warranty

Dimensions

Ø: 7" x H: 2 3/16"

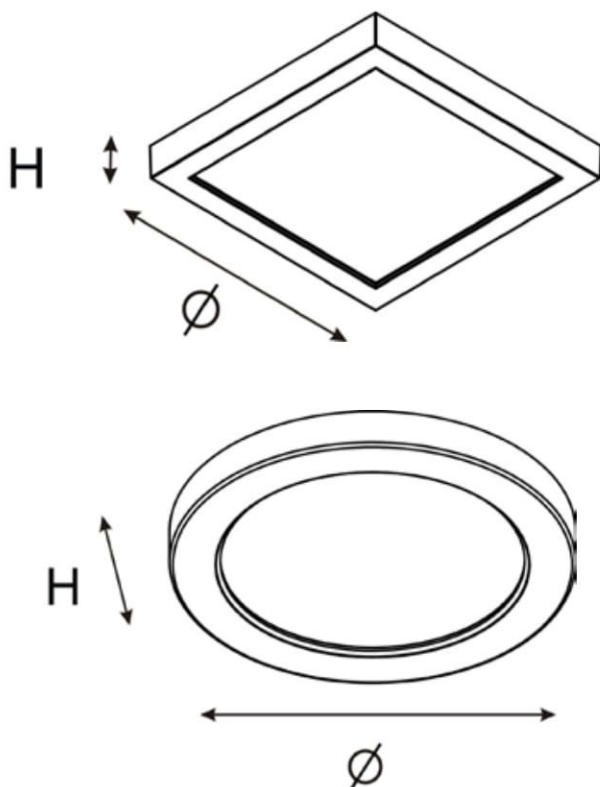

Light Distribution

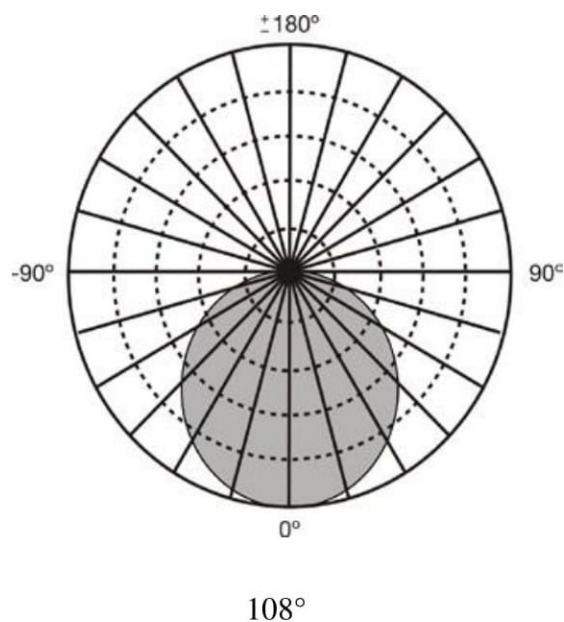

LED CEILING LIGHT



1055 CLARK BLVD, BRAMPTON, ON, L6T 3W4 Canada
9057998009

Emergency

24 hours recharge time

>90 minute operation from battery

over-charge/discharge protection

Dimensions

Ø: 5 1/2"xH:2 3/16"

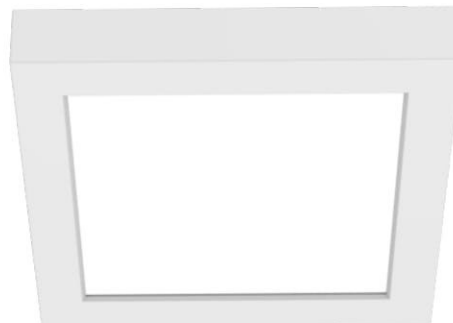

Installation Instruction

Fast and Easy Installation

- Mounts directly to any 3" and 4" junction boxes
- The quick connector makes easy and fast connection, the universal mounting plate ensure a clean and tight fit.



Simply screw the unique design universal mounting plate to the junction box



Make your connections using the quick connect included, and fit into place.



Snap the fixture onto the mounting plate.

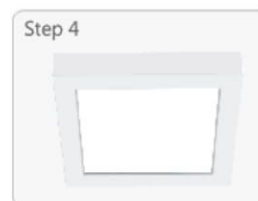

Installation finished, Enjoy the sleek ceiling.

Ordering Guide

Series	Input Voltage	Dimmable	CCT	Finish	Emergency System
<input type="checkbox"/> BL6-FM7 7"Round LED Flush Mount Ceiling	<input type="checkbox"/> 110V <input type="checkbox"/> 277V <input type="checkbox"/> 110V-277V	<input type="checkbox"/> Non-Dimmable <input type="checkbox"/> Dimmable	<input type="checkbox"/> 2700K <input type="checkbox"/> 3000K <input type="checkbox"/> 4000K <input type="checkbox"/> 5000K <input type="checkbox"/> 6000K <input type="checkbox"/> Tunable	<input type="checkbox"/> White <input type="checkbox"/> Bronze <input type="checkbox"/> Satin Nickel	<input type="checkbox"/> Without Emergency Batty Backup <input type="checkbox"/> With Emergency Batty Backup
<input type="checkbox"/> BL6-SFM7 7"Square LED Flush Mount Ceiling			(3000K, 4000K, 5000K, choose any 2 of them)		