

AF6D-IA
6 inch Compact Fluorescent New Construction IC Airtight Recessed Housing

Catalog #		Prepared by		LiteHarbor
Project		Date		
Notes				

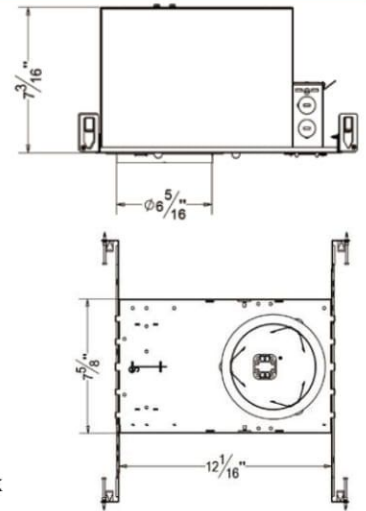

6 inch Compact Fluorescent New Construction IC Airtight Recessed Housing

Housing

- 1) Die-formed aluminum for maximum heat dissipation and rust protection
- 2) Designed for New Construction installation
- 3) Housing can be installed in 1/2" to 1-3/8" thick ceilings.

Hanger Bar

- 1) Allow housing to be positioned and locked at any point within a 24" joist span.
- 2) Can be shortened for 12" joists
- 3) Can be positioned on long or short axis of the housing
- 4) Contain integral nail
- 5) Hanger fit onto T-bar spline for quick alignment

Junction Box

- 1) ETL listed for through branch wiring
- 2) 4 in-4 out J-box
- 3) Designed for straight through conduit runs
- 4) 1/2" and 3/4" romex wiring knockouts

Order Matrix

A	B	C	D
---	---	---	---

Item No.:AF6D-IA

A	Series
AF6D-IA	6"/ Compact Fluorescent New Construction IC Airtight Housing

B	Input Voltage
277	120V
277	277V

C	Wattage
F32	CFL 32W

RECESSED DOWNLIGHT



1055 CLARK BLVD, BRAMPTON, ON, L6T 3W4 Canada
9057998009

Ballast

- 1) Thermally protected
- 2) Electronic ballast provides full light output and rated lamp life
- 3) Flicker free and noise free operation and starting
- 4) End of lamp life protection is standard
- 5) Attached to junction box cover so it may be serviced from below the ceiling no tools required

D	Color Temperature
28K	2800k
35K	3500K
50K	5000K
60K	6000K

Lamp & Socket

See Trim for max. wattage and lamp

CRI>80%

PF>0.9

Color Temperature:2800K-6500K

Listing

ETL listed for damp location W/Feed through

Other Special requirement please confirm with factory



6" COMPACT FLUORESCENT TRIM OPTICS



RV6002

**6 inch Vertical Reflector
Self Flanged/White Ring**

RECESSED DOWNLIGHT



1055 CLARK BLVD, BRAMPTON, ON, L6T 3W4 Canada
9057998009