

A6-PRIA
6 inch Remodel IC Airtight Slope
Recessed Housing

Catalog #		Prepared by		LiteHarbor
Project		Date		
Notes				



6 inch Remodel IC Airtight Slope Recessed Housing

Housing

- 1) Die-formed aluminum for maximum heat dissipation and rust protection
- 2) Designed for Remodel installation
- 3) Housing can be installed in 1/2" to 1-3/8" thick ceilings.

Junction Box

- 1) ETL listed for through branch wiring
- 2) 4 in-4 out J-box
- 3) Designed for straight through conduit runs
- 4) 1/2" and 3/4" romex wiring knockouts

Lamp

See trim for max. wattage and lamp
 CRI>80%
 PF>0.9
 Color Temperature: 2700K-6500K

Listing

ETL listed for damp location W/Feed through

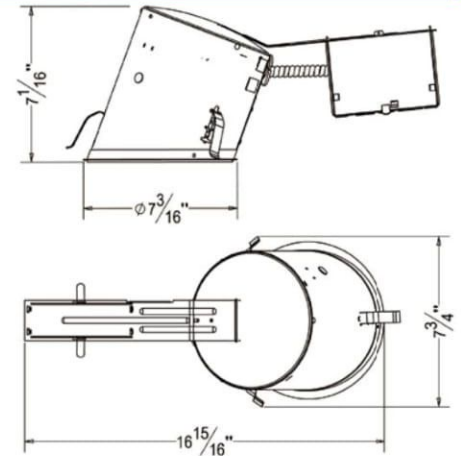

Order Matrix

A B C D E

Item No.:A6-PRIA

A	Series
A6-PRIA	6"/ Remodel IC Airtight Slope Housing

B	Input Voltage
120V	
277	277V

C	Lamp
P30	PAR30
R30	R30

D	Wattage
L12	LED 12W
L18	LED 18W

RECESSED DOWNLIGHT



Other Special requirement please confirm with factory

E	Color Temperature
28K	2800k
35K	3500K
50K	5000K
60K	6000K



6" TRIM OPTICS



BP6001

6" Slope Trim With Baffle

Lamp: R30/PAR30 LED E26 18W Max.



BP6002

6" Slope Trim With Reflector

Lamp: R30/PAR30 LED E26 18W Max.